

ITEM #: _____	QTY: _____
MODEL #: _____	
PROJECT NAME: _____	

082120

3601 S. Banker St. Effingham, IL 62401 • P.O. BOX 609 • Ph: (888) 431-2667 • Fax: (800) 433-2667

"PBJC" JANITOR CABINET WITH MOP SINK



FEATURES:

- TYPE 300 STAINLESS STEEL WITH #4 POLISH SATIN FINISH
- ALL EXPOSED HARDWARE IS TAMPER PROOF
- INCLUDES OVERHEAD SHELF FOR CHEMICAL STORAGE
- (2) SWING LOCKABLE LOUVERED DOORS
- (1) OVERSIZED MOP SINK
- BOTTOMS OF BOWLS FORMED FOR DRAINAGE TO 3-1/2" DIAMETER DIE STAMPED OPENING
- INCLUDES (1) HEAVY DUTY SERVICE FAUCET (PBF-SS-6)
- INCLUDES (1) 10" SERVICE FAUCET HOSE (PB-HOSE-120)
- (2) SHELF MOUNTED MOP HOLDERS WITH LOCKING CAMS
- MOUNTING LOCATION OF SERVICE FAUCET CAN BE SPECIFIED BY KITCHEN EQUIPMENT CONTRACTOR
- 3-1/2" DRAIN ACCEPTS 2" MALE DRAIN PIPE

CONSTRUCTION:

- CABINET: STAINLESS STEEL CABINETS TIG WELDED, EXPOSED EDGES ARE POLISHED TO MATCH ADJACENT SURFACE

MATERIAL:

- CABINET: 18GA TYPE 300 STAINLESS STEEL WITH #4 POLISH, SATIN FINISH
- 18 GAUGE TYPE 300 CABINET
- 16 GAUGE TYPE 300 SINK BOWL AND DECK



PBJC-303084



PBF-SS-6



PB-HOSE-120

JANITOR CABINET WITH MOP SINK

MODEL	QTY
PBJC-303084	
PBJC-222584	

DETAILED SPECIFICATIONS

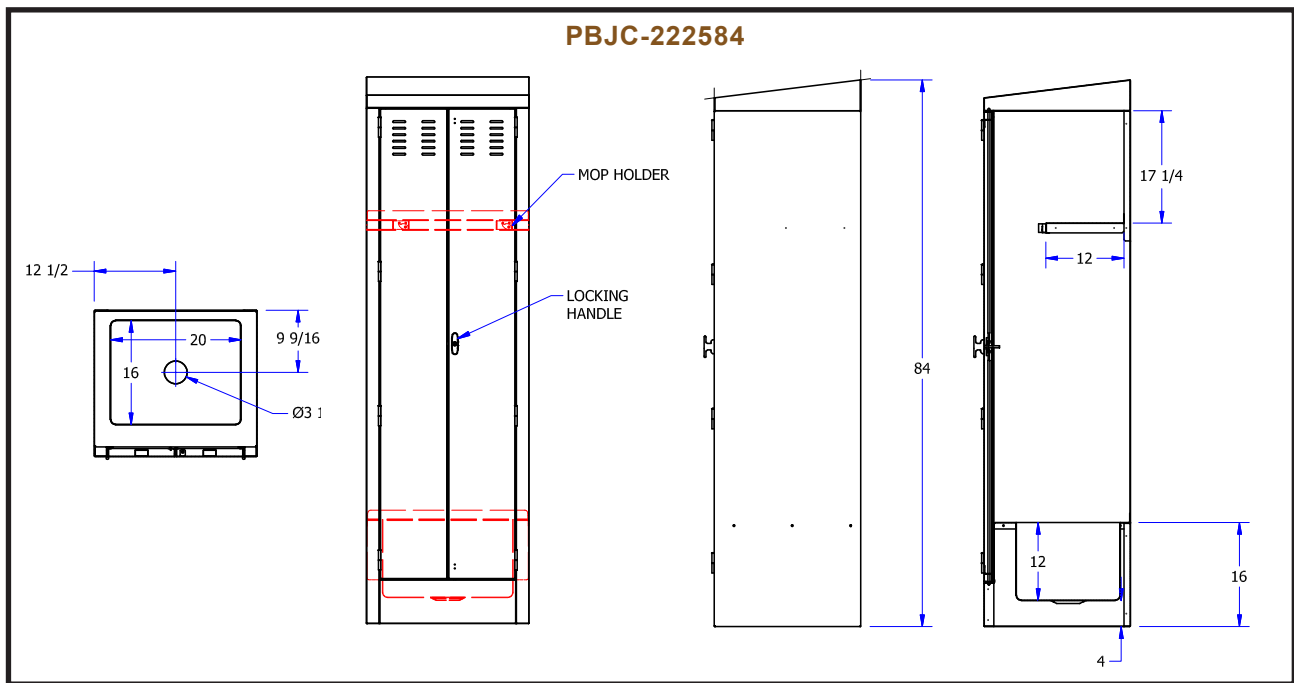
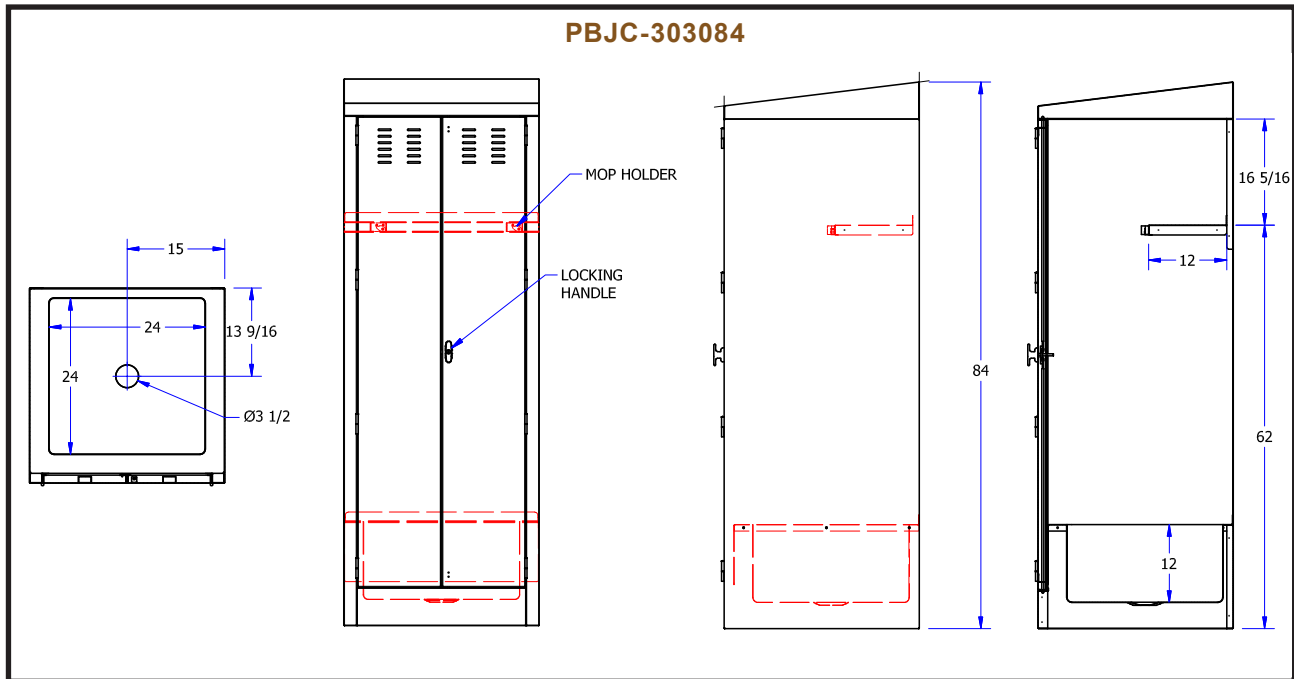

JANITOR CABINET WITH MOP SINK

MODEL	OVERALL SIZE (LxWxH)	MOP SINK SIZE (LxWxH)	WT. (LBS)
PBJC-303084	30" X 30" X 84"	24" X 24" X 12"	213
PBJC-222584	25" X 22-1/2" X 84"	16" X 20" X 12"	169

SOME UNITS SHIP UNASSEMBLED FOR REDUCED SHIPPING COST. ALL DIMENSIONS ARE TYPICAL. TOLERANCE +/- .500"
 John Boos & Co. is constantly engaged in a program of improving products and therefore reserves the right to change specifications without prior notice.



3601 S. Banker St. • Effingham, IL 62401 • PO BOX 609 • quotes@johnboos.com

www.johnboos.com